



# Powered Asset Gateway

CBL-AG-BABS / CBL-AG-BPLC

**INSTALL GUIDE - TRAILER ..... 2-5**

**IMPORTANT SAFETY AND USE INFORMATION ..... 6**



[samsara.com/fleet-app](https://samsara.com/fleet-app)



## CABLE DIAGRAM

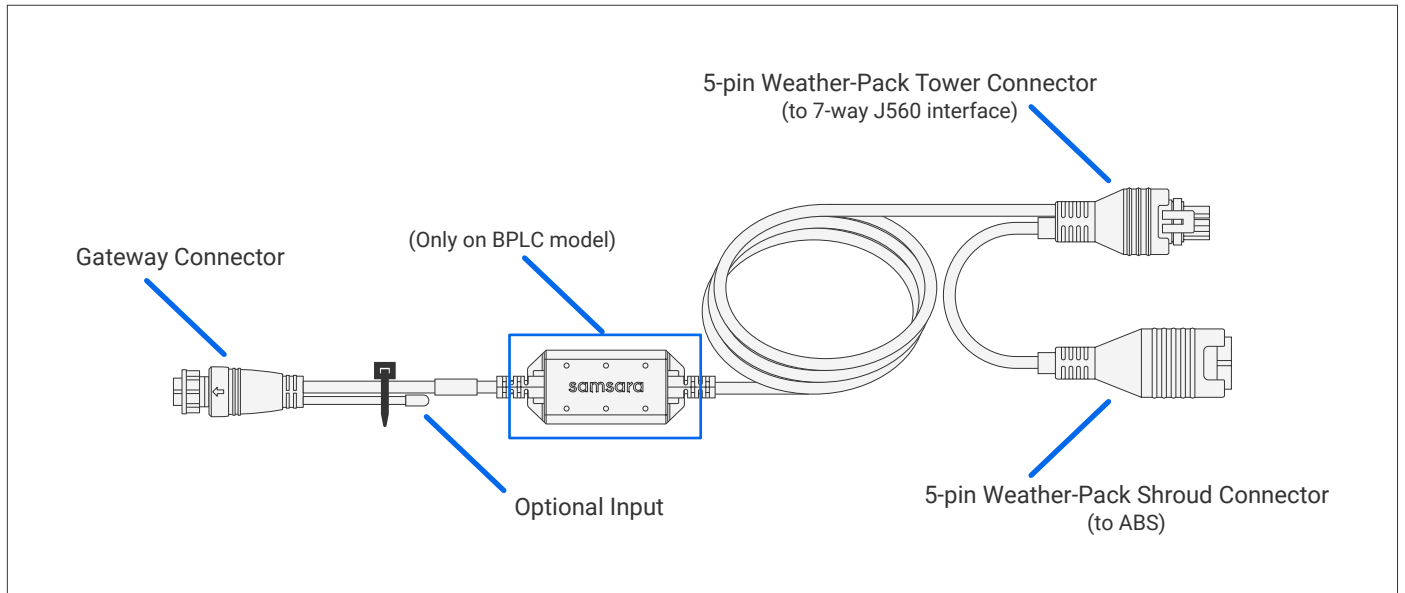

## WHAT YOU'LL NEED

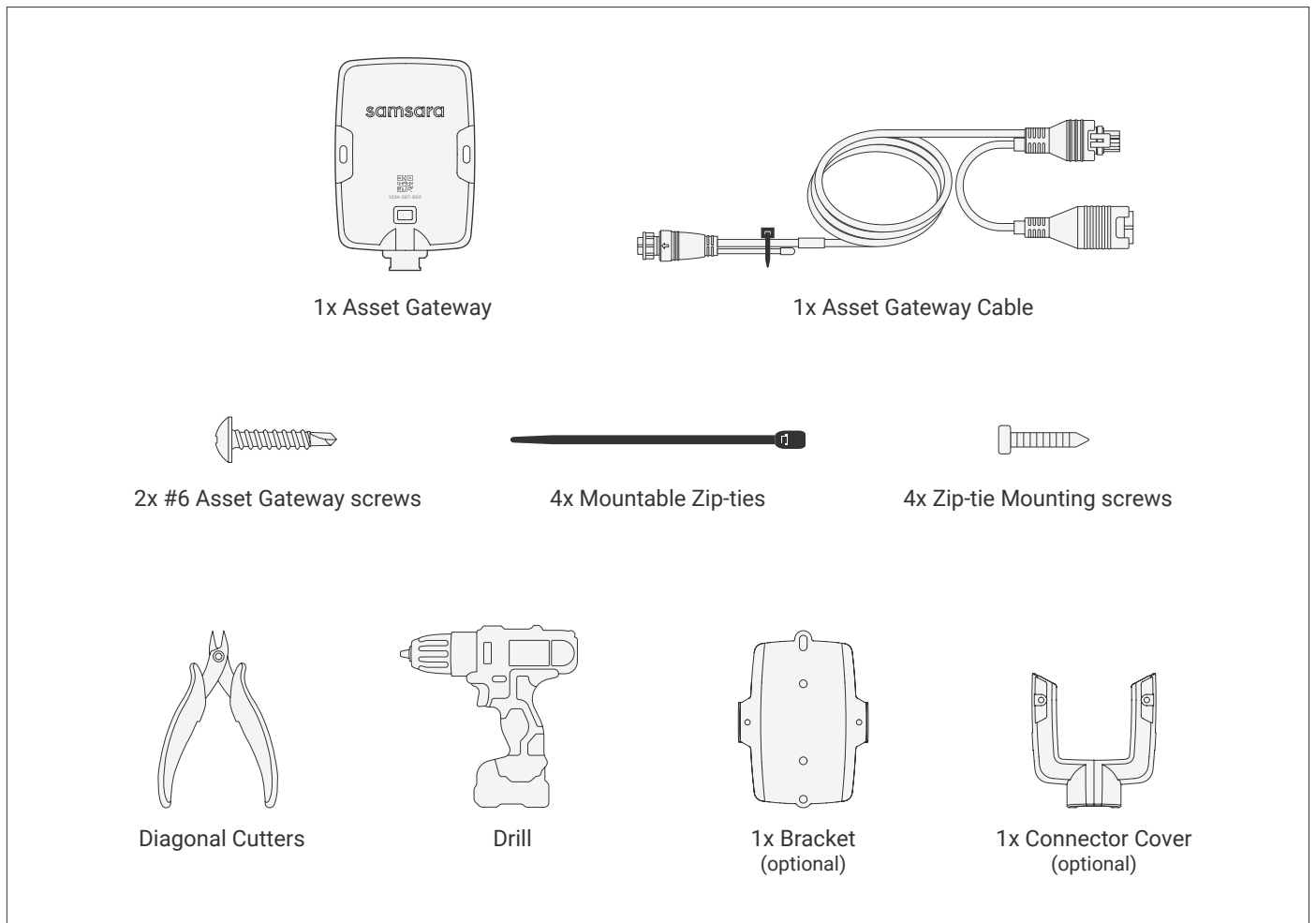

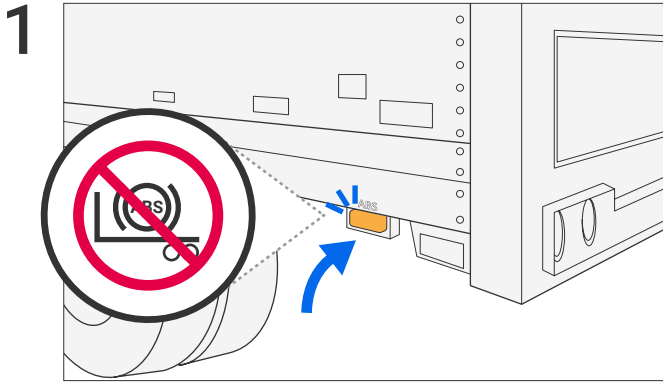

1 Before you attempt installation of the AG on your trailer, ensure that the ABS is in good working order: after trailer startup, the ABS light comes on for 3 to 5 seconds during startup before it powers off. Any other outcome may indicate a problem with the trailer ABS system. Turn off the power to the trailer.

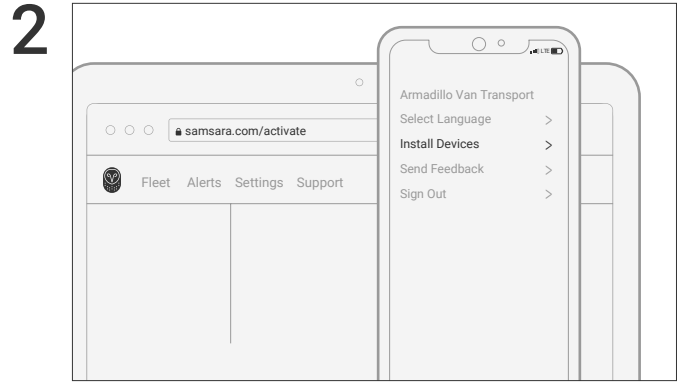

2 Activate your Asset Gateway. This can be completed on the [Samsara Dashboard](https://samsara.com) or on the [Samsara Fleet App](#).

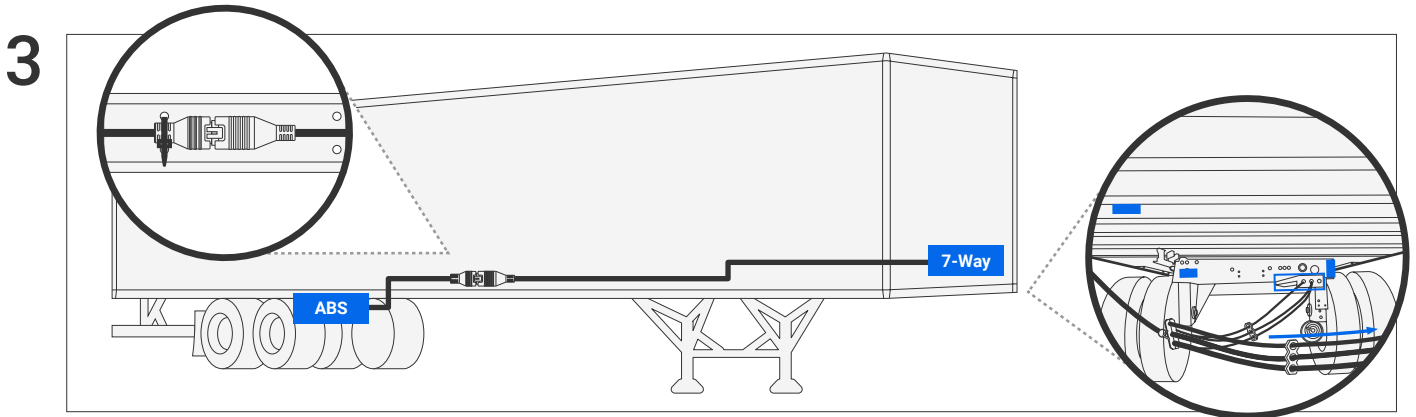

3 Locate and disconnect the 5-pin ABS Weather-Pack (“TTMA”) connector on your trailer (typically located near the rear axle). To locate the connector, trace the wire harness from the ABS unit.

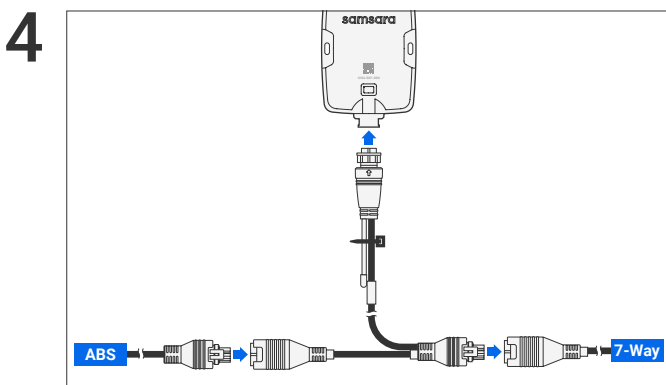

4 Connect the trailer’s 5-pin connection to the Samsara cable using both of the two connectors you’ve just disconnected.

**WARNING:** Ensure both connections are fully mated and retaining latch is engaged.

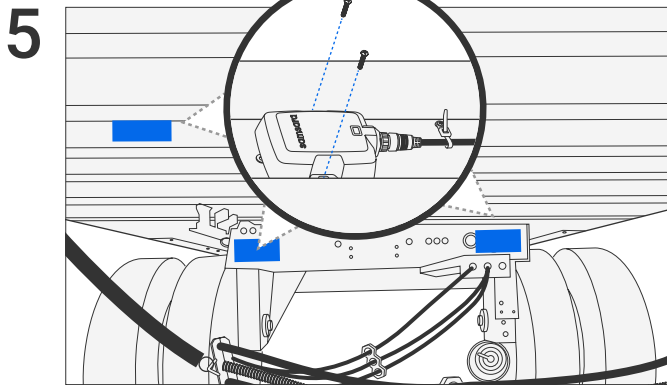

Select the desired mounting location. For best GPS and cellular connectivity results, mount as close to the edge of the trailer as possible and consider the motion of the moving parts that may damage the device or the cables. If possible, test the device in the desired mounting location before installation.

When selecting a location for your device, reference the following tips:

Ensure that the AG has at least one unobstructed side, ideally with a clear view of the sky or the ground. Avoid installing the device within metallic structures, such as within metal trailers. Placement in such structures may adversely impact device cellular and GPS connectivity.

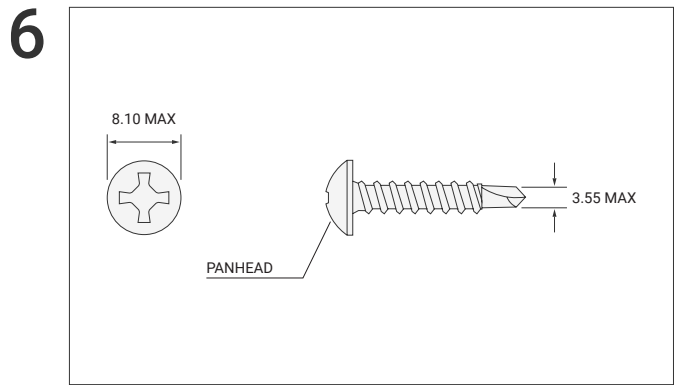

Mount the AG with the two provided screws or with screws less than or equal to #6 size, with a maximum torque of 1.4 Nm (12.4 lbf-in).

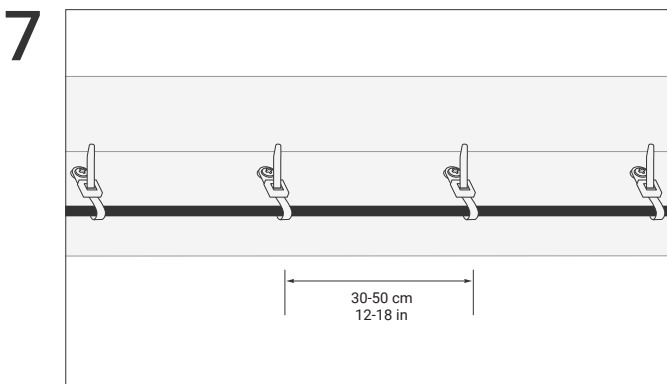

Secure the wire harness every 30 to 50 cm using cable ties while ensuring that the cables are free from sharp edges, bending load, or tension.

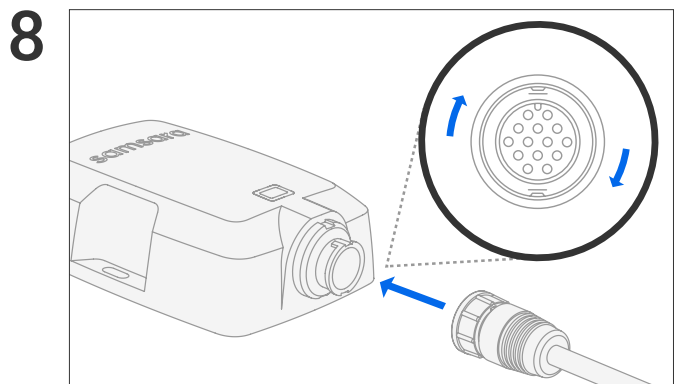

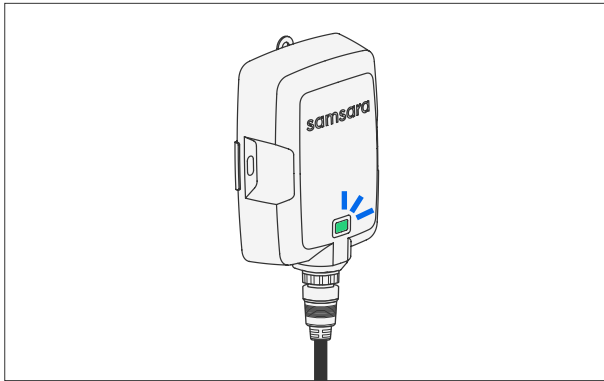

Plug the cable into the AG and twist to lock.

9



Turn on power to the trailer and verify that the trailer's ABS system is functioning properly as described in step 2. Now that the AG is powered, verify the connection in the Samsara dashboard. After a successful connection, the LED will turn green.

<b>AG53</b>		<b>AG52</b>		
	Blink white		Blink green	First boot
	Green		Green	GPS & LTE OK
	Blue		Blue	No GPS, LTE OK
	Red		Red	No GPS, No LTE
	Red		Amber	No LTE, GPS OK

## IMPORTANT SAFETY INFORMATION

This installation guide contains typical information specific to products manufactured at the time of its publication. The contents of this guide do not constitute a warranty and are for reference only. Consult applicable local laws and ordinances to determine any installation restrictions. It is the installer's responsibility to comply with all applicable laws and ordinances when installing this hardware.

Do not attempt to repair this product, use any third party replacement parts with this product, or otherwise modify this product except in accordance with product manuals or as otherwise instructed by Samsara. Failure to do so may cause property damage, lead to physical injury, or void your product warranty.

Any installation not in accordance with the instructions in the installation guide or otherwise in the Documentation or other than as described by the relevant IP rating or recommended operating conditions may result in physical injury or property damage. Failure to follow these directions could result in serious injury or death.

This hardware and any associated software may not be compatible with third party products and/or services and may interfere with the operations of or void warranties for such third party products and/or services.

Do not install or adjust hardware while driving or operating the vehicle. Do not install this hardware in a location that could interfere with the driver's visibility or operation of vehicle controls. Do not install this hardware on or near airbag panels or within the working range of an airbag.

Do not install hardware while the vehicle is unsecured. Do not install hardware while the vehicle is turned on unless instructed to turn on the vehicle by the installation guide. Failure to follow installation instructions may cause serious physical injury, damage to the vehicle or the hardware, and void vehicle or other third party product warranties.

Batteries in the hardware may have a shorter life span if not used in accordance with instructions. Do not short circuit, crush, disassemble, heat above 60°C (140°F), incinerate, or expose the battery or its contents to water. Do not remove the battery from the hardware to recharge or for any other reason, including disposal. Do not solder directly to the battery cell. Do not use if battery appears damaged.

This product includes capacitors and batteries which may present a potential fire, explosion, electric shock, or burn hazard. Do not touch or come into close proximity to any capacitors within this hardware.

Keep this hardware between -40°C/-40°F to 60°C/140°F externally powered, -20°C/-4°F to 60°C/140°F discharging on battery, and 0°C/32°F to 45°C/113°F charging. Failure to keep this hardware in the specified temperature range may result in safety risks.

Failure to follow mounting instructions may create risk of physical injury or property damage from falling objects. If mounting the hardware to a building wall, check for wiring or plumbing before drilling any holes.